



1



STEP 1:

Slide the Hitch Pin/Ball shank into the adjustable block, lining the holes up.

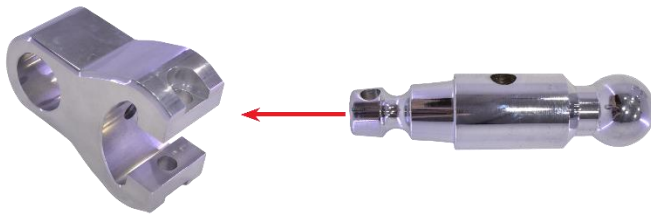

STEP 2:

Slide in securing pin with threaded hole facing towards the exit. Place rubber washer inside to secure pin in place. Threaded hole is to assist in pin removal if necessary.

2

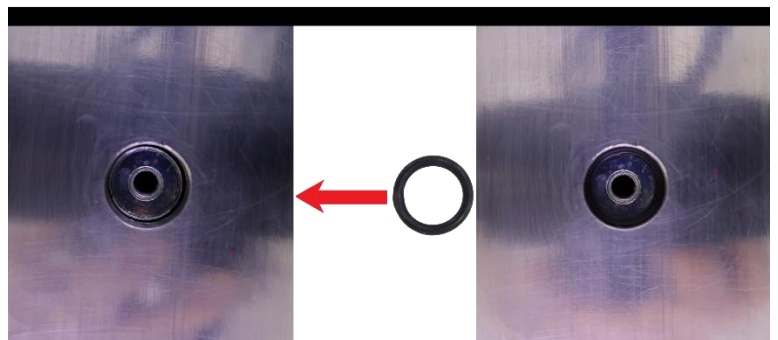
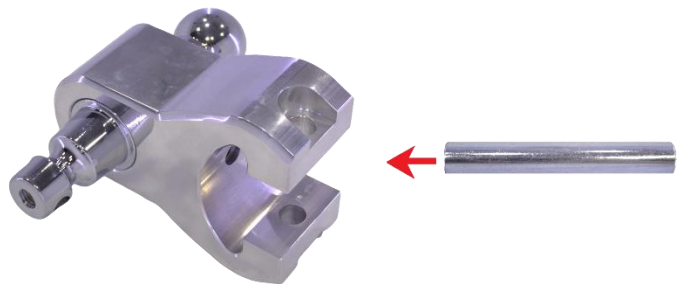



3

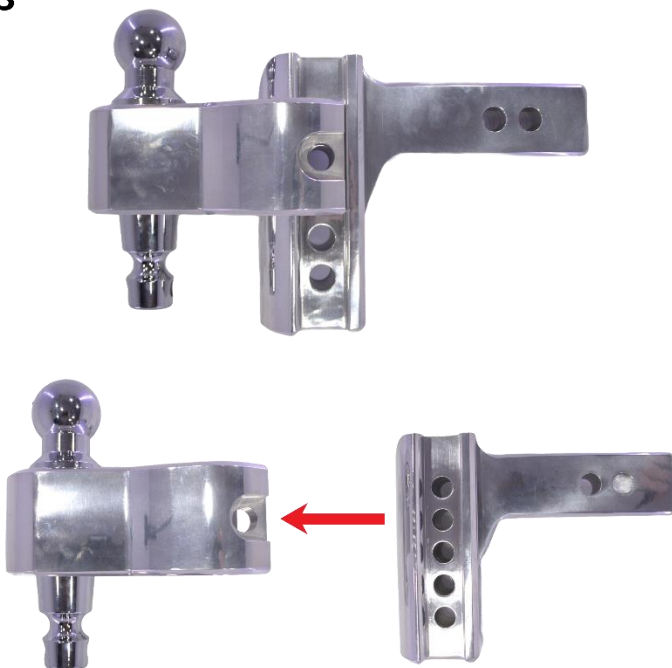

STEP 3:

Slide adjustable block onto the hitch and choose desired height and orientation.

STEP 4:

Slide in securing pin into desired hole and secure with R-Clip.

4

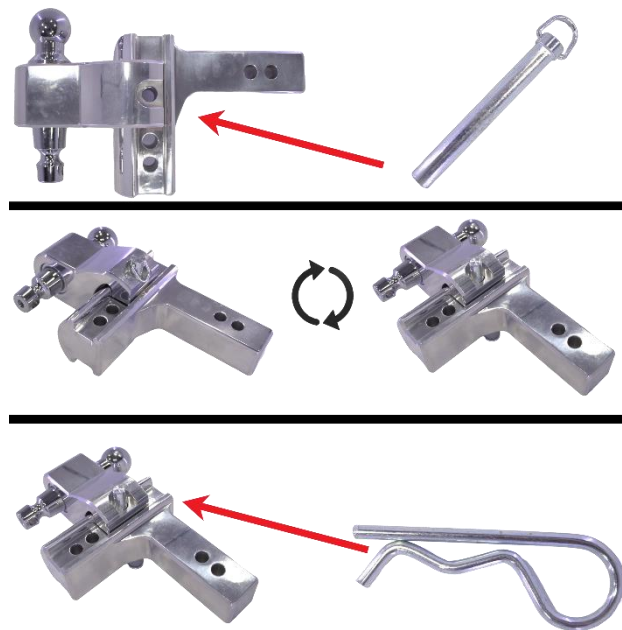

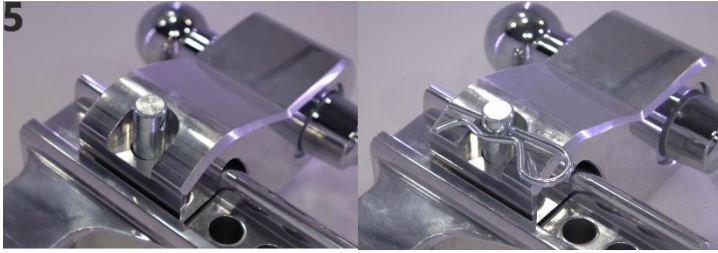

STEP 5:

Once R-Clip is secure, you are now ready to use your new McHitch Adjustable Tow Tongue with McHitch Tow Pin and 50mm Ball.

