



# CANNING X19

**Expand Your Horizons, Embrace Luxury**



**BUILT TOUGH, BUILT TO LAST**

[austrackcampers.com.au](http://austrackcampers.com.au)

1800 797 797

**\$94,990**

**\$341 Per Week Financed\***

\*Excluding registration costs. \*\*Conditions apply. Rates may change without notice. ^Comparison rate based on a \$50,000 loan over 7 years with weekly repayments. WARNING: The comparison rate applies only to this example. Different amounts and terms may result in different rates. Additional fees, charges, and savings (e.g., fee waivers) are not included but may affect the cost. Finance subject to lender criteria. Assistance provided under Austrack Finance Australian Credit Licence 422959. Images are indicative only. Specifications subject to change.









**2600KG** (app.)  
TARE

**3200KG**  
ATM

**204KG** (app.)  
BALL WEIGHT

**RENOGY**  
POWER MANAGEMENT

**MCHITCH**  
COUPLING

**ARK**  
JOCKEY WHEEL



Electric  
Expandable



Large  
Island Bed



Independent  
Shower and Toilet



2 x 230Ah  
Lithium



900W  
Solar



Aircon and  
Diesel Heater

## Expand What You Know About Luxury

The Canning X19 is our most luxurious caravan for couples. With a large island bed, full kitchen, and ample storage, its expanding design offers extra space and comfort, ensuring every journey feels like a five-star retreat, no matter where you roam.

**VIEW SPECS**



**7.722M**

**2.514M**

**3.099M**



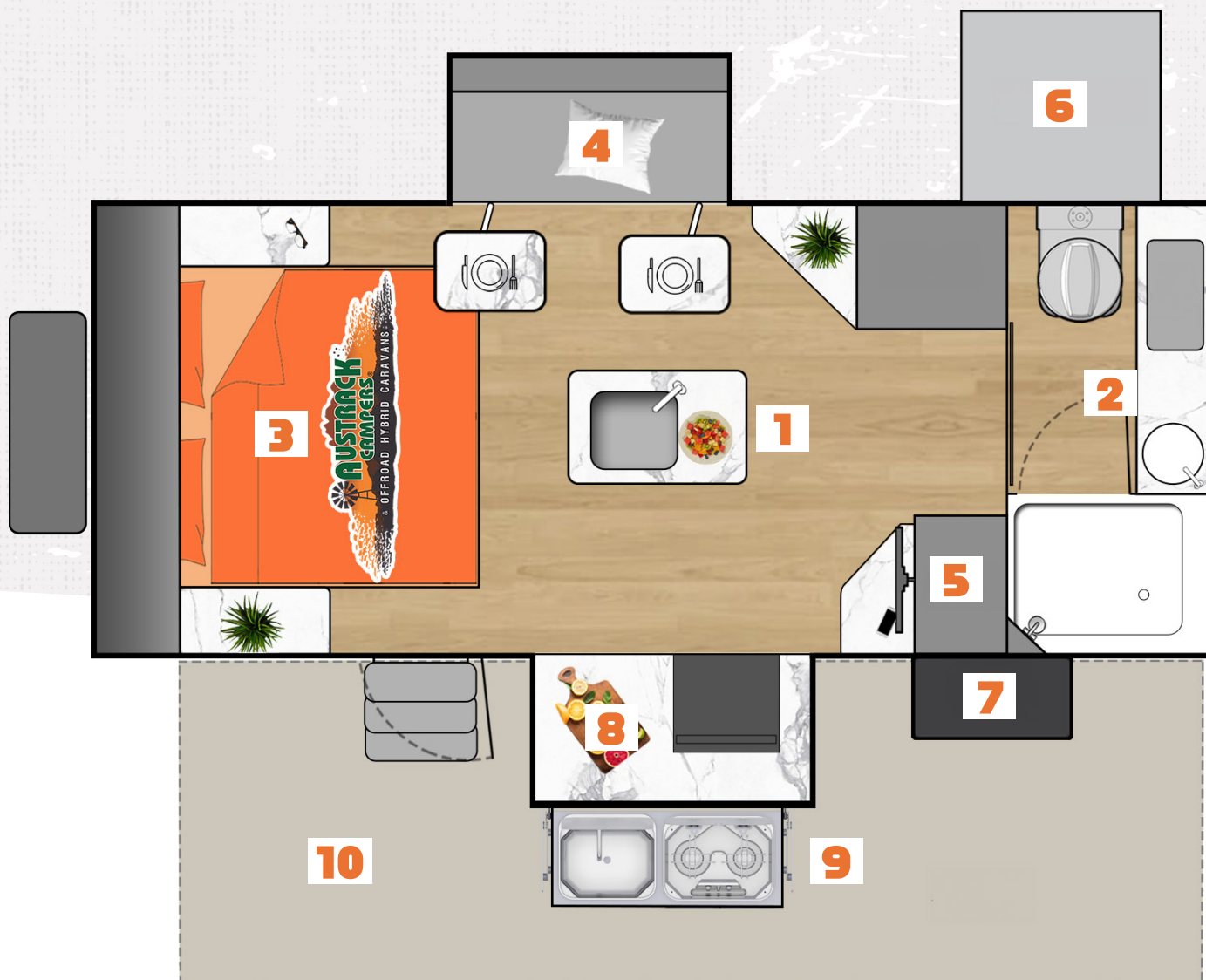

<b>1. Expanded Living</b>	Spacious living area, with electric expandable sides. Island with sink and countertop space
<b>2. Ensuite</b>	Independent shower and toilet, sink, front-loading washing machine, illuminated mirror
<b>3. King Size Bed</b>	Luxury large island inner-pocket spring bed
<b>4. Lounge Area</b>	Plush semi enclosed lounge/ study nook with two movable tables
<b>5. Appliances</b>	150L fridge, microwave and smart TV with storage area
<b>6. Extra Shower</b>	Convenient external shower with removable ensuite tent
<b>7. Preparation Area</b>	Sturdy preparation area/ tray for cooking or working
<b>8. Indoor Kitchen</b>	Four-burner cooktop & grill, spacious countertop
<b>9. Outdoor Kitchen</b>	Slide out external kitchen with double-burner stove and sink
<b>10. Electric Awning</b>	Electric awning for simple set-up, complete with antiflep kit & 3 walls



**BUILT TOUGH, BUILT TO LAST**

[austrackcampers.com.au](http://austrackcampers.com.au)

1800 797 797